

嘉尼赫®
JAINNHER®



41Q5482

精密立式磨床

CNC Vertical Grinding Machine
JHV-1008CNC





應用範圍

本機專門設計用於船艙、航空器等大型運輸產業、能源產業、工具機精密零組件、油壓元件等需要高精度零件之研磨。

APPLICABLE INDUSTRIES

- Ships, aircraft of large transportation
- Energy
- Precision machine tool components
- Hydraulic components

創新結構設計概念!!

Innovative Structural Design Concepts!

機台主結構

本機台主體結構採用高級鋁塊FC-30經正火化熱處理，採低溫凍乾處理，以增強其機械強度，有效確保穩定、固定、耐腐蝕。機械結構設計主要考慮負荷、速度、精度與穩定性。為了達到以上強度條件，結構件的設計採用較為穩固的三角形作為設計基礎，較優的三角設計則可符合力學增加結構曲率穩定與抗振動性。

MACHINE MAIN STRUCTURE

They are cast of high grade FC-30 (see), melted by advanced induction furnace, then cast in resin cans. In order to ensure stability and rigidity, they are heat-treated with normalizing procedure prior to machining.

This mechanical structure major consider load, speed, accuracy and stability. In order to achieve above conditions, the structure was designed with a more stable triangle fit of principle. It can be increased rigidity against bending and torsional rigidity.

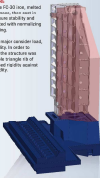

C型結構設計

此結構設計解決X軸受重力影響直線度問題，減少了立柱的受力變形，大大改善X軸與Z軸的直線度。

C TYPE MACHINE STRUCTURE

This C-type machine structure design was to solve X axis straightness problem that influenced from gravity also alleviate column deformation by stress, it totally improve X and Z axes straightness, reduce Z axis loaded and guide way straightness deviation.



傾斜式軌道

X軸採用傾斜式軌道設計，可以利用重力消除間隙，並且增加剛性，更加快排液改善水溫影響床台精度問題。



SLANT GUIDE WAY

X axis adopt slant guide way designing it can be eliminated gap through gravity and increase machine rigidity, improve coolant draining speed and avoid coolant temperature affect machine accuracy.

工作臺水平調整裝置

工作轉盤採用2斜圓相互契合與轉動原理，自然形成可調整水平裝置，補償X軸與Z軸的垂直度誤差與Z軸軌道垂直度誤差，更加提升機台整體與加工物的幾何精度。

WORK TABLE HORIZONTAL ADJUSTMENT DEVICE

It can adjust workpieces cylindricity deviation. Work table adopts two ramps fit each other and rotation principle, become an adjustable leveling device, to compensate X and Z axes perpendicularity deviation and Z axis guide way straightness deviation, more over to enhance machine structure and workpiece geometric accuracy.

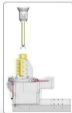

高性能!!

High Performance!!

液靜壓工作轉盤

德國製造之液靜壓工作轉盤 提供精準的軸向及徑向精度 並可承載1,200 公斤的重量

HYDROSTATIC TABLE

Germany made hydrostatic rotary table with very good axial and radial run out.

The workpiece weight can be hold 1,200kg



角度軸

砂輪主軸可以依據工件之角度手動旋轉± 30° 以研磨所需的角度

ANGULAR AXIS

Grinding wheel head spindle can be manually rotated ± 30°, in order to grind request taper.



砂輪(選配) GRINDING WHEEL(OPTIONAL)



OD 砂輪選擇
外径磨輪量測
長度 30~250mm

MOB 砂輪選擇
3000~12000rpm
內孔選擇量
內徑 80~120 高度
50~100mm

MFB 砂輪選擇
8000~12000rpm
內孔選擇量
內徑 30~70 高度
50~100mm

FD 砂輪選擇
4000~12000rpm
內孔選擇量
內徑 30~50 高度
100~200mm

IO 砂輪選擇
2000~12000rpm
內孔選擇量
內徑 30~100 高度
50~100mm

OD wheel arbor,
for OD
Workpiece length
30~250mm

MOB wheel arbor
3000~12000 rpm,
ID use
80~120 length
50~100mm

MFB wheel arbor
8000~12000 rpm
ID use
30~70 length
50~100 mm

FD wheel arbor
4000~12000rpm
ID use
30~50 length
100~200mm

IO wheel arbor
2000~12000rpm
ID use
30~100 length
50~100mm



A 發那科控制系統Fanuc Oi-TF controller



B 德國製靜壓轉盤
Hydrostatic rotary table
(Made in Germany)



C 油箱 / 泵浦Coolant tank/pump



D 半罩式鈹金
Semi splash guard

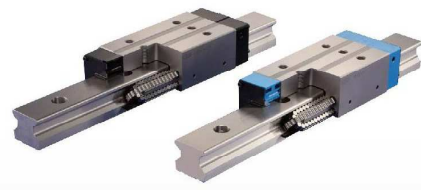

E 日製線性滑軌
Linear guide way (Made in Japan)



F 自動潤滑系統
Automatic lubrication system



G 工具及工具箱
Tool kits and toolbox



H 工作燈
Work lamp



I 水平調整螺絲及墊塊
Leveling bolts and blocks



J 刀庫系統(不含砂輪和接桿)
Tool magazine(not included wheel & arbor)

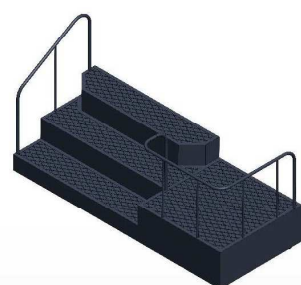

K 階梯
Ladder



L 油霧回收機
Oil mist device

高精度!! 卓越!!

High Precision!! Outstanding!!

標準配件 Standard Accessories



② 易握式磨輪
Easy-grip grinding wheel (strong attachment)



③ 直線尺
Linear scale

選搭配件 Optional Accessories



④ 磁筒過濾器+紙帶過濾器
Magnetic separator+ Paper filter (MCBB+PF80)



⑤ 延長主軸
Extended spindle



⑥ 治具(依工件)
Fixture (depend on workpiece)



⑦ 插桿及砂輪
Arbor & Grinding wheel

Items	Model	JHV-1000CNC	
加工 Capacity	內孔研磨尺寸範圍	Range of I.D. grinding	Ø50 – Ø800 mm
	外圓研磨尺寸範圍	Max. O.D. grinding	Ø1,000 mm
	Z 軸研磨最大高度 (外徑)	Z axis max grinding altitude (OD)	800 mm
	Z 軸研磨最大高度 (內徑)	Z axis max grinding altitude (ID)	Ø50 – Ø250 / 325 mm Ø250 – Ø800 / 800 mm
	最大研磨直徑	Max. swing diameter	1,000 mm
	可安裝的工件高度	Max. installed parts altitude	800 mm
	工作台載重	Max. work table loaded	1,200 kg
控制系統 Control System	中心高(工作台至主軸)	Center high (table to spindle)	1,800 mm
	控制系統	Controller	Fanuc 0i-TP
行程 Stroke	X 軸左右移動	X axis travel (horizontal)	1,800 mm
	Z 軸上下移動	Z axis (vertical)	1,700 mm
主軸 Wheel Head Spindle	砂輪迴轉速度	Grinding wheel rpm	1,800 – 13,000 rpm
	砂輪直徑	Grinding wheel diameter	45 – 305 mm
	最高使用周速	Max. peripheral	33 m/s
	砂輪主軸馬力	Grinding wheel spindle motor	15 HP (20 HP) / 11 (15) kw
角度軸 Angular axis	砂輪孔(刀把規格)	Spindle taper	HSK100A
	工件軸 Work head spindle	Work head spindle rpm	10 – 240 rpm
工件夾頭 Work table	工作台/夾頭尺寸	Work table	1,000 mm
	T 槽規格尺寸	T-Slot nut	M12
進給 Feed	X/Z 軸快速進給	X/Z Rapid speed	X axis 10 m/min Z axis 6 m/min
	X/Z 軸最小設定單位	X/Z min. setting unit	0.001mm
	X/Z 軸每刻度移動量	X/Z min. movement in scale	0.001mm
	X/Z 軸滑動方式	X/Z	線性滑軌 Linear Guide way
自動換刀系統 ATC	自動交換數	Automatic exchange no.	0
	刀庫形式	Tool magazine type	圓盤臥立式 Umbrella type
	砂輪軸錐孔形式	Spindle taper	HSK100A
	交換方式	Exchange type	X/Z 軸伺服移動 X/Z servo movement
馬達 Motor	最大砂輪直徑	Max. grinding wheel diameter	305
	工件主軸馬達	Spindle head motor	7kw at F 30/3000
	砂輪主軸馬達	Grinding wheel spindle motor	15kw at I 15/12000
	X 軸用	X-axis	8kw at F 60/3000
Z 軸用	Z-axis	8kw at S 60/3000	
機台尺寸 Machine Measurements	長*寬*高	Length x Width x Height	5,450x3,100x5,500
	淨重	Net Weight	25,000 kg

嘉尼赫機械股份有限公司
JAINNHER MACHINE CO.,LTD.

昆山嘉尼赫機械有限公司
KUN SHAN JAINNHER MACHINE CO.,LTD.

40768台中市西屯區台中工業區28路333號
No.333,28th Rd. Taichung Industrial Park,
Taichung, Taiwan 40768
Tel:886-4-2358 5299 Fax:886-4-2359 4803
saledep@jainnher.com
www.jainnher.com

江蘇省昆山市周市鎮金茂路900號3棟3樓
3F, Building 3, No.900, Jinmao Road,
Zhouzhen town, Kunshan City, Jiangsu, China
Tel:+86-512-8186 7171 / +86-512-8186 7575
Fax:+86-512-8186 7979