

續表>>  
Continu

訂貨型號 Order Code	L	D	夾持範圍Ød Clamping range	重量(Kg) Weight
BT50-SD16-100	100	41	2.75~16	3.9
-150	150			4.3
-200	200			4.7
-SD20-100	100	50	4~20	4.2
-150	150			4.8
-200	200			5.3
SD25-100	100	55	6~25	4.2
-150	150			5.0
-200	200			5.9

**EMC強力銑刀刀柄-BT柄**  
EMC POWERFUL MILL HOLDERS-BT(MAS403) SHANK

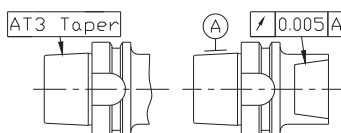
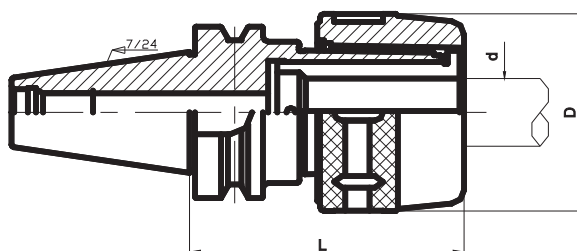

訂貨型號 Order Code	L	ØD	夾持範圍Ød Clamping range	重量(Kg) Weight
BT30-EMC20-80	80	53.5	6~20	0.9
BT40-EMC20-80	80	53.5	6~20	1.7
-135	135			2.0
BT40-EMC32-90	90	73.5	6~32	2.2
-120	120			2.9
BT50-EMC32-105	105	73.5	6~32	5.0
-135	135			5.9
-165	165			6.7
-EMC42-115	115	87.5	6~42	5.7

★ 單獨訂購均不帶筒夾及扳手，如有需要請另外訂購，也可訂購套裝產品（附帶筒夾7個及扳手1把）。  
The collet and spanner are not include, please order them additionally if necessary. The tool package of whole set is available on request. (include a spanner and 7 collets)



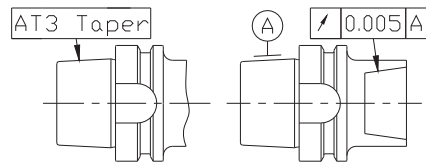
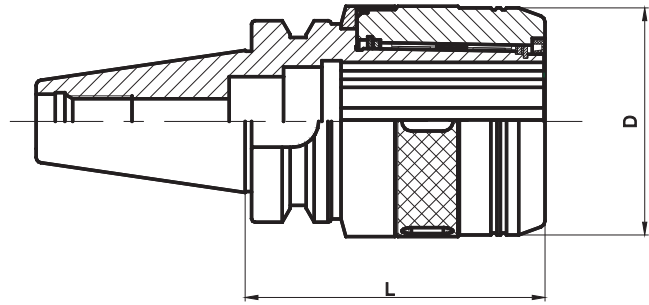

訂貨型號 Order Code	L	ØD	夾持範圍Ød Clamping range	重量(Kg) Weight
BT30-PMC20-80	80	53.5	6-20	3.9
BT40-PMC20-80	80	53.5	6-20	4.3
-135	135			4.7
BT40-PMC32-105	105	72	6-32	4.2
-120	120			4.8
BT50-PMC32-105	105	72	6-32	5.3
-135	135			4.2
-165	165			5.0
-PMC42-115	115	87.5	6-42	5.9



※前套與本體結合部採用防塵罩與O形圈雙重防塵，防塵效果好，能有效地避免切屑進入內部而損壞內部零部件，從而影響刀柄使用與加工精度。

The connection between the tool cutter and the holder has an O ring and a dust proof cover .This design can prevent chips,dust,dirt and so on from getting into the holder.It also avoids filings from damaging the part, and affecting product precision,thus assuring machining accuracy.

★單獨訂購均不帶筒夾及扳手，如有需要請另外訂購，也可訂購套裝產品（附帶筒夾7個及扳手1把）。  
The collet and spanner are not include,please order them additionally if necessary. The tool package of whole set is available on request.(include a spanner and 7 collets)

